



3330 Dixie-Narco Blvd.
Williston, SC 29853
www.dixienarco.com

M098.2

DN5800-4/3800-4 BevMax 4

CARD READER INSTALLATION with MILLED BEZELS

Revised 03/29/10



Models Affected: All DN5800/3800 (BevMax 4) Model Venders

Instructions on installing a card reader in DN5800-4/3800-4 (BevMax 4) machines.

BM4 Card Reader Kit: Part No. 657,004,10X.X4

Contents

Part No.	Description	Quantity
647,054,60x.x3	Assy. Pem stud card reader bracket	1
800,304,21x.x1	Screw, 8-32x1/2	4
800,801,54x.x1	Hex nut, 8-32	8
624,050,84x.x3	Spacer, Bill Validator	1
M098.x	Installation Instructions	1

*Installation also requires a milled top bezel not included with kit. Order as required:

Top Coke Bezel ass'y. milled - CR0005574 and Decal 803,887,87x.x1

Top Dasani Bezel ass'y. milled with decal - CR0005575

Top Gray Bezel ass'y. milled - CR0005760

Note: Because of the rounded nature of the bezel, the milled bezels help set the reader nose piece out farther to allow card swipe access.

** 657,050,70x.x3 Validator mounting ring for top bezel required when mounting card reader in the center bezel.

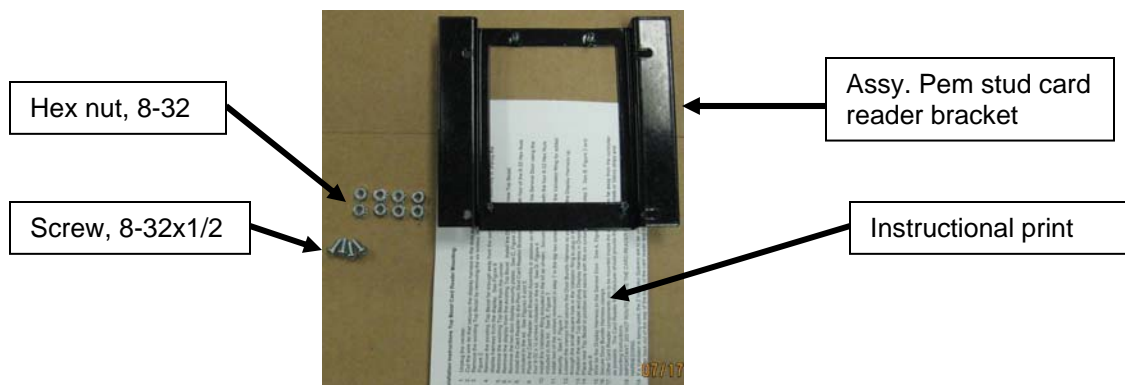



Top Bezel

Figure 1

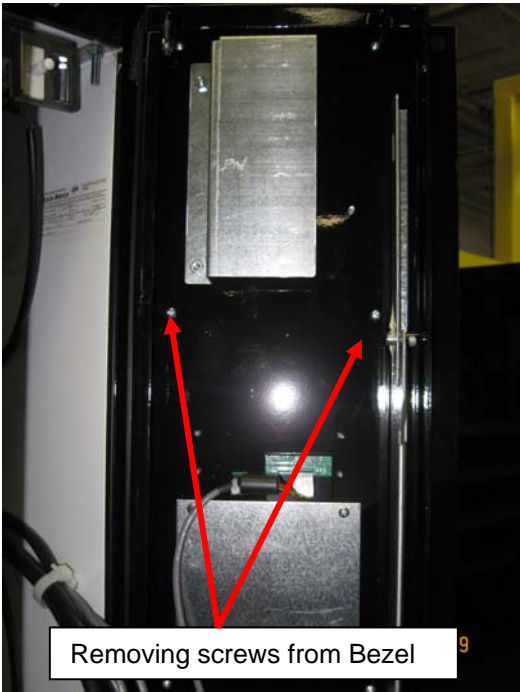

Removing screws from Bezel

Figure 2

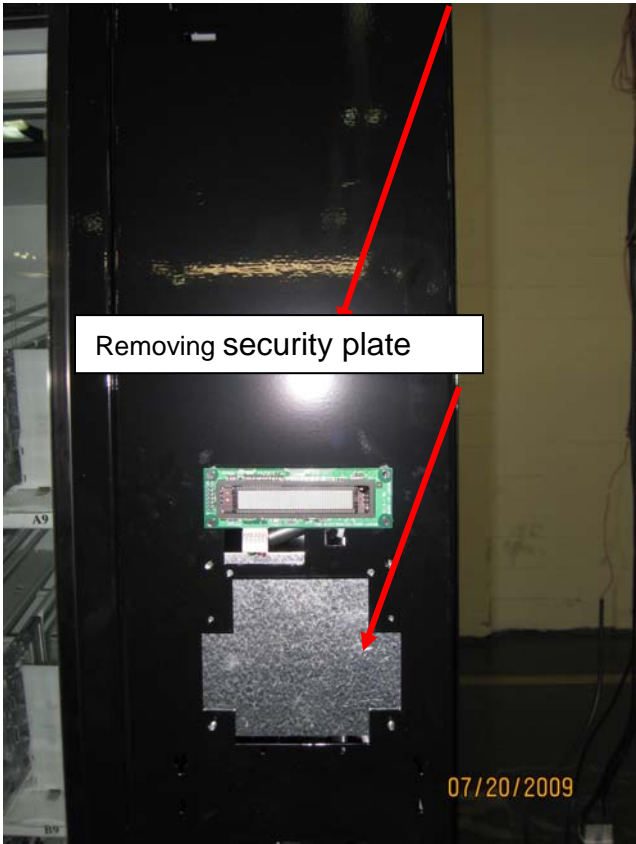

Removing security plate

Figure 3

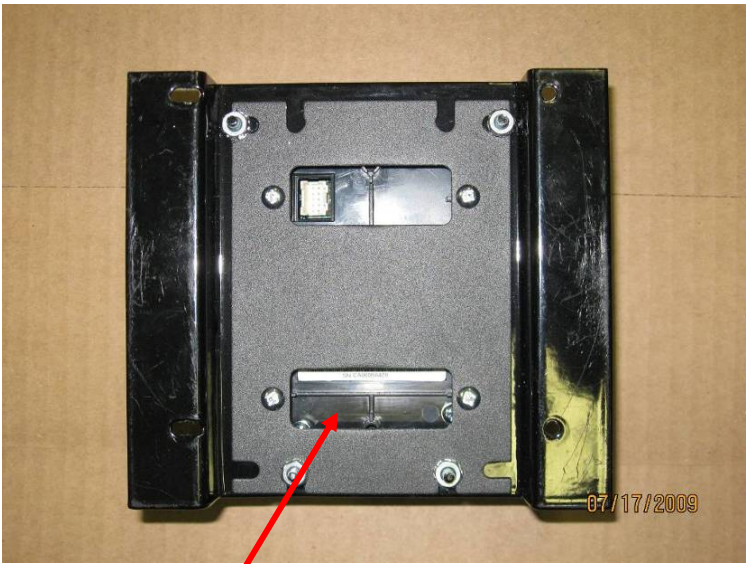

Figure 4

Install the Card Reader to the Pem Stud Card Reader Bracket Assembly



Figure 5

Secure using 8-32 x
½ screws

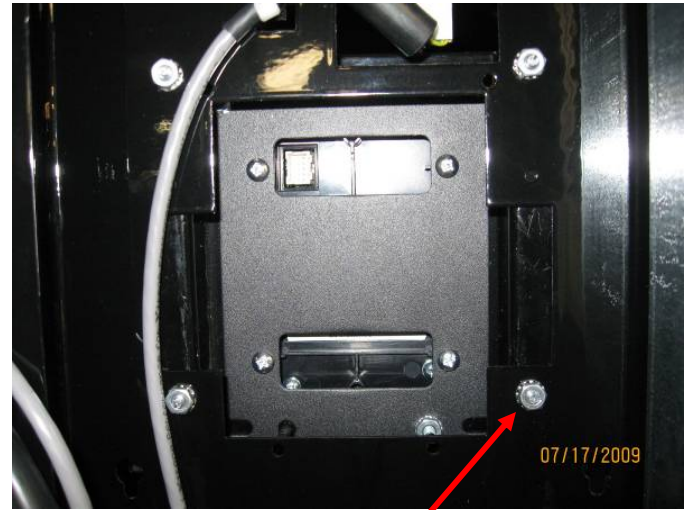

Figure 6

Secure the 8-32
screws with the four
8-32 Hex Nuts

Installation Instructions Top Bezel Card Reader Mounting:

1. Toggle the on/off switch to the off position or unplug the main power cord to the vender.
2. Remove the existing Top Bezel by removing the six screws on the inside of the service door. **See Figure 1 & 2.**
3. Remove the door display security plate. **See Figure 3.**
4. Install the Card Reader to the Pem Stud Card Reader Bracket Assembly with four of the 8-32 Hex Nuts included in the kit. **See Figures 4.**
5. Place the Card Reader and Bracket Assembly in position on the out side of the Service Door and secure using the four 8-32 x ½ screws on the inside of the service door secure the 8-32 screws with the four 8-32 Hex Nuts Included in the kit. **See Figure 5 & 6.**
6. Install the Milled Top Bezel in position and secure with the six screws removed in step 1.
7. Other Card Reader components are to be mounted inside the service area as far away from the controller as possible. The Card Reader Manufacturer should provide the needed brackets or Velcro strips and mounting instructions.
8. **IMPORTANT: DO NOT ROUTE OR TIE THE CARD READER HARNESSING TO THE VENDER HARNESSING.**
9. If a Validator is being used, the 2 Validator Spacers are to be used if needed to space the Validator Stacker back out of the way of the back of the card reader and its harnessing.
10. Check to ensure all wiring is plugged in to proper locations. Check for any damaged wiring.
11. Plug in vender.
12. Test vender for proper operation.